

# SALTER®

SINCE 1760

O·M·B·R·E

## 2-Slice Toaster

Practical, stylish design  
for everyday use



Please read all of the instructions carefully and retain for future reference.

## **Safety Instructions**

When using electrical appliances, basic safety precautions should always be followed.

Check that the voltage indicated on the rating plate corresponds with that of the local network before connecting the appliance to the mains power supply.

Children aged from 8 years and people with reduced physical, sensory or mental capabilities or lack of experience and knowledge can use this appliance, only if they have been given supervision or instruction concerning use of the appliance in a safe way and understand the hazards involved.

Children should be supervised to ensure that they do not play with the appliance.

Unless they are older than 8 and supervised, children should not perform cleaning or user maintenance.

This appliance is not a toy.

This appliance contains no user serviceable parts. If the supply cord, plug or any part of the appliance is malfunctioning, or if it has been dropped or damaged, only a qualified electrician should carry out repairs. Improper repairs may place the user at risk of harm.

Keep the appliance and its power supply cord out of the reach of children.

Do not immerse the electrical components of this appliance in water or any other liquid.

Do not leave the appliance unattended whilst connected to the mains power supply.

Use of an extension cord with the appliance is not recommended.

This appliance should not be operated by means of an external timer or separate remote control system.

This appliance is intended for domestic use only. It should not be used for commercial purposes.

If this appliance falls or accidentally becomes immersed in water, unplug it from the wall outlet immediately. Do not reach into the water.



**Caution:** Hot surface – do not touch the hot section or heating components of the appliance.

Take care not to pour water on the heating element.

Do not toast pastries with runny fillings or frosting.

Do not toast torn slices of bread.

**Warning:** Keep the appliance away from flammable materials.

## Care and Maintenance

**STEP 1:** Before attempting any cleaning or maintenance, unplug the toaster from the mains power supply and allow to fully cool.

**STEP 2:** Wipe the toaster housing with a soft, damp cloth and dry thoroughly.

**STEP 3:** Remove crumbs from inside the base of the toaster by sliding open the crumb tray.

Never use harsh or abrasive cleaning detergents or scourers to clean the toaster, as this could damage the surface.

**Caution:** Never place fingers near or inside the toasting slots.

Always unplug the toaster and allow it to cool thoroughly before attempting to remove any bread that has become stuck inside the toasting slot.

Take care when removing food from the toasting slot to avoid damage to the internal mechanism and heating element.

Do not allow crumbs to build up inside the base of the toaster.

Empty the crumb tray periodically.

Do not operate the toaster without bread, as this may cause damage to the toaster.

## Description of Parts

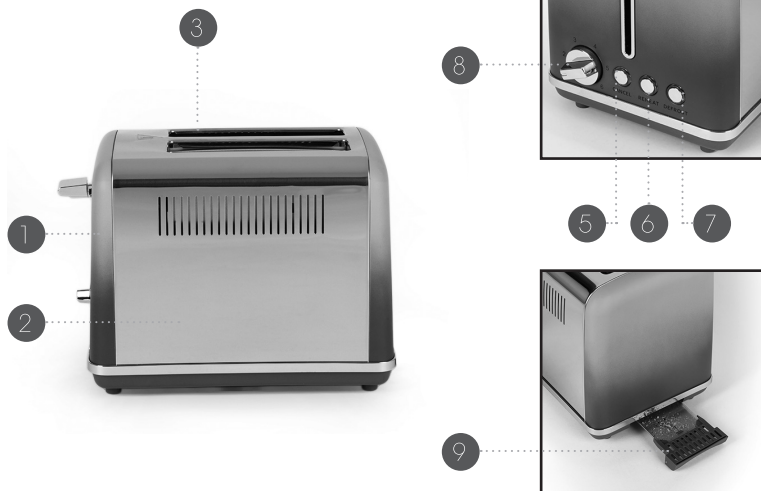

1. Ombré 2-slice Toaster
2. Toaster housing
3. Toasting slots
4. Loading lever
5. Cancel button

6. Reheat button
7. Defrost button
8. Browning control dial
9. Removable crumb tray

## Before First Use

Before using the toaster for the first time, wipe the toaster housing with a soft, damp cloth and dry thoroughly.

Do not immerse the toaster in water or any other liquid.

Never use harsh or abrasive cleaning detergents or scourers to clean the toaster, as this could cause damage.

**Note:** When using toaster for the first time, a slight smoke or odour may be emitted. This is normal and will soon subside. Allow for sufficient ventilation around the toaster.

## Using the Ombre 2-slice Toaster

**STEP 1:** Place the toaster onto a flat, stable surface at a height that is comfortable for the user. Make sure that the crumb tray is pushed fully into the toaster and that the loading lever is in the upright position, with no bread or other objects inserted to the toasting slots.

**STEP 2:** Plug in and switch on the toaster at the mains power supply. Then turn the browning control dial to the desired setting. Select 3–4 for medium brown toast.

**STEP 3:** Insert the bread or toasting food into the toasting slot(s) and lower the loading lever until it is locked into place. Toasting will begin when the loading lever is fully down.

**STEP 4:** When the toast reaches the selected browning level, the toast will pop up automatically. Turn the toaster off and unplug it from the mains power supply.

**STEP 5:** Remove the food and any crumbs from the toast slot(s) using heat-resistant gloves. Gently lift the loading lever to raise the toast out of the toasting slots so that it can be more easily removed.

**Note:** To interrupt toasting mid-setting, press the Cancel button. The Cancel button will remain illuminated throughout the toasting cycle.

The crumb tray should be emptied periodically.

**Caution:** Never use a fork or sharp-edged utensil to remove toast, as this may damage the heating element or cause injury.

## Using the Defrost / Reheat Setting

Insert the frozen or cold bread into the toasting slot(s) and lower the loading lever until it is locked into position and press the Defrost or Reheat button to activate the setting.

## Automatic Centring Guides

Lowering the loading lever closes the centring guides and holds the bread centrally in the toasting slots.

## **Storage**

The toaster must be cool, clean and dry before storing in a cool, dry place. Never wrap the cord tightly around the toaster; wrap it loosely to avoid causing damage.

## **Specifications**

Product code: EK4324

Input: 220–240 V~ 50/60 Hz

Output: 870 W

## Connection To The Mains

Please check that the voltage indicated on the product corresponds with your supply voltage.

### Important

As the colours in the mains lead of this appliance may not correspond with the coloured markings identifying the terminals in your plug, please proceed as follows:

The wires in the mains lead are coloured in accordance with the following code:

#### Blue Neutral (N)

#### Brown Live (L)

**FOR UK USE ONLY** - Plug fitting details  
(where applicable).

The wire coloured **BLUE** is the **NEUTRAL** and must be connected to the terminal marked **N** or coloured **BLACK**.

The wire coloured **BROWN** is the **LIVE** wire and must be connected to the terminal marked **L** or coloured **RED**.

On no account must either the **BROWN** or the **BLUE** wire be connected to the **EARTH** terminal ( $\perp$ ).

Always ensure that the cord grip is fastened correctly.

The plug must be fitted with a fuse of the same rating already fitted and conforming to BS 1362 and be ASTA approved.

If in doubt, consult a qualified electrician who will be pleased to do this for you.

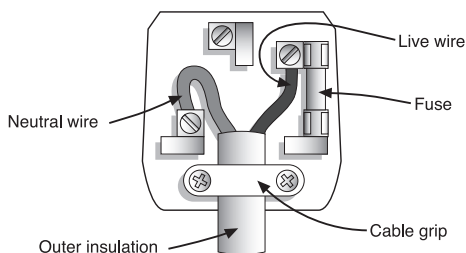

### Non-Rewireable Mains Plug

If your appliance is supplied with a non-rewireable plug fitted to the mains lead and should the fuse need replacing, you must use an ASTA approved one (conforming to BS 1362 of the same rating).

If in doubt, consult a qualified electrician who will be pleased to do this for you.

If you need to remove the plug, **DISCONNECT IT FROM THE MAINS**, then cut it off the mains lead and immediately dispose of it safely. Never attempt to reuse the plug or insert it into a socket outlet as there is a danger of an electric shock.

**UP Global Sourcing UK Ltd.,  
UK. Manchester OL9 0DD.  
Germany. 51149 Köln.**

If this product does not reach you in an acceptable condition please contact our Customer Services Department at **[www.saltercookshop.com](http://www.saltercookshop.com)**.

## **Guarantee**

All products purchased as new carry a manufacturer's guarantee; the time period of the guarantee will vary dependent upon the product. Where reasonable proof of purchase can be provided, Salter will provide a standard 12 month guarantee with the retailer from the date of purchase. This is only applicable when products have been used as instructed for their intended, domestic use. Any misuse or dismantling of products will invalidate any guarantee.

Under the guarantee, we undertake to repair or replace free of any charge any parts found to be defective. In the event that we cannot provide an exact replacement, a similar product will be offered or the cost refunded. Any damages from daily wear and tear are not covered by this guarantee, nor are consumables such as plugs, fuses etc.

Please note that the above terms and conditions may be updated from time to time and we therefore recommend that you check these each time you revisit the website.

Nothing in this guarantee or in the instructions relating to this product excludes, restricts or otherwise affects your statutory rights.

The crossed out wheellie bin symbol on this item indicates that this appliance needs to be disposed of in an environmentally friendly way when it becomes of no further use or has worn out. Contact your local authority for details of where to take the item for recycling.





\*To be eligible for the extended guarantee, go to **www.saltercookshop.com** and register your product within 30 days of purchase.



Find us on 

[www.facebook.com/SalterCookshop](http://www.facebook.com/SalterCookshop)

# SALTER®

Manufactured by:

UP Global Sourcing UK Ltd.,

**UK.** Manchester OL9 0DD.

**Germany.** 51149 Köln.

Made in China.

