

# **SALTER®**

SINCE 1760

 **ELDER**

## 2-Slice Toaster



Please retain instructions for future reference.

## **Safety Instructions**

When using electrical appliances, basic safety precautions should always be followed.

Check that the voltage indicated on the rating plate corresponds with that of the local network before connecting the appliance to the mains power supply.

Children aged from 8 years and people with reduced physical, sensory or mental capabilities or lack of experience and knowledge can use this appliance, only if they have been given supervision or instruction concerning use of the appliance in a safe way and understand the hazards involved.

Children should be supervised to ensure that they do not play with the appliance.

Unless they are older than 8 and supervised, children should not perform cleaning or user maintenance.

This appliance is not a toy.

If the power supply cord, plug or any part of the appliance is malfunctioning or if it has been dropped or damaged, cease using the product immediately to avoid potential injury.

This appliance contains no user serviceable parts, only a qualified electrician should carry out repairs. Improper repairs may place the user at risk of harm.

Keep the appliance and its power supply cord out of the reach of children.

Keep the appliance out of the reach of children when it is switched on or cooling down.

Keep the appliance and its power supply cord away from heat or sharp edges that could cause damage.

Keep the power supply cord away from any parts of the appliance that may become hot during use.

Keep the appliance away from other heat emitting appliances.

Do not allow the power supply cord to hang over worktops, touch hot surfaces or become twisted.

Do not immerse the electrical components of this appliance in water or any other liquid.

Do not operate the appliance with wet hands.

Do not expose the appliance to rain.

Do not leave the appliance unattended whilst connected to the mains power supply.

Do not remove the appliance from the mains power supply by pulling the cord; switch it off and remove the plug by hand.

Do not pull or carry the appliance by its power supply cord.

Do not use the appliance for anything other than its intended use.

Do not use any accessories other than those supplied.

Do not use this appliance outdoors.

Do not store the appliance in direct sunlight or in high humidity conditions.

Do not move the appliance when it is in use.

Do not touch any sections of the appliance that may become hot during use, as this may cause injury.

Bread can burn. Never use the appliance near or below flammable materials, such as curtains, wall cupboards or shelves.

Always unplug the appliance after use and before any cleaning or user maintenance.

Always ensure that the appliance has cooled fully after use before performing any cleaning or maintenance or storing away.

Always use the appliance on a stable, heat-resistant surface, at a height that is comfortable for the user.

Use of an extension cord with the appliance is not recommended.

This appliance should not be operated by means of an external timer or separate remote control system.

This appliance is intended for domestic use only. It should not be used for commercial purposes.

The outer surface of the appliance may get hot during operation.

If this appliance falls or accidentally becomes immersed in water, unplug it from the wall outlet immediately. Do not reach into the water.



**CAUTION:** Hot surface – do not touch the hot section or heating components of the appliance.

Take care not to pour water on the heating element.

Do not toast pastries with runny fillings or frosting.

Do not toast torn slices of bread.

**WARNING:** Keep the appliance away from flammable materials.

## Care and Maintenance

**STEP 1:** Before attempting any cleaning or maintenance, unplug the toaster from the mains power supply and allow to fully cool.

**STEP 2:** Wipe the toaster housing with a soft, damp cloth and dry thoroughly.

**STEP 3:** Remove crumbs from inside the base of the toaster by sliding open the removable crumb tray following the instructions in the section entitled 'Removable Crumb Tray'. Do not immerse the toaster in water or any other liquid. Never use harsh or abrasive cleaning detergents or scourers to clean the toaster, as this could damage the surface.

**CAUTION:** Never place fingers near or inside the toasting slots. Always unplug the toaster and allow it to cool thoroughly before attempting to remove any bread that has become stuck inside the toasting slot.

Take care when removing food from the toasting slot to avoid damage to the internal mechanism and heating element. Do not allow crumbs to build up inside the base of the toaster. Do not operate the toaster without bread, as this may cause damage to the toaster.

If the toaster falls into water, unplug it from the mains power supply immediately. Do not reach into the water.

## Description of Parts

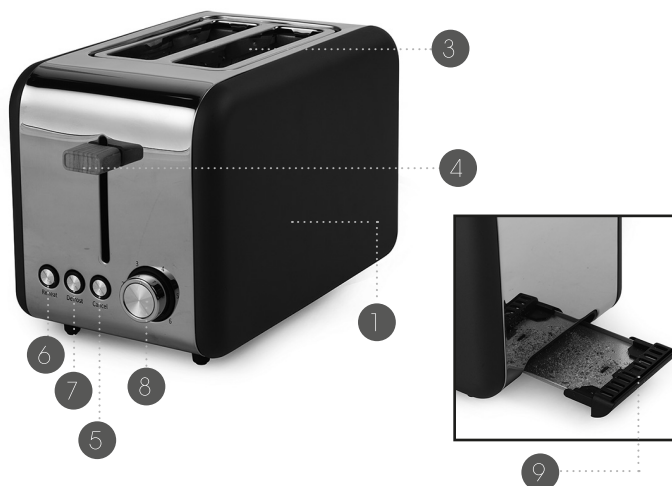

- |                              |                          |
|------------------------------|--------------------------|
| 1. 2-slice Toaster main unit | 6. Reheat button         |
| 2. Toaster housing           | 7. Defrost button        |
| 3. Toasting slot(s)          | 8. Browning control dial |
| 4. Loading lever             | 9. Removable crumb tray  |
| 5. Cancel button             |                          |

## Instructions for Use

### Before First Use

Before using the toaster for the first time, wipe the toaster housing with a soft, damp cloth and dry thoroughly.

Do not immerse the toaster in water or any other liquid.

Never use harsh or abrasive cleaning detergents or scourers to clean the toaster, as this could cause damage.

**NOTE:** When using the toaster for the first time, a slight smoke or odour may be emitted. This is normal and will soon subside. Allow for sufficient ventilation around the toaster.

## Using the 2-slice Toaster

**STEP 1:** Place the toaster onto a flat, stable surface at a height that is comfortable for the user. Make sure that the removable crumb tray is pushed fully into the toaster and that the loading lever is in the upright position, with no bread or other objects inserted to the toasting slots.

**STEP 2:** Plug in and switch on the toaster at the mains power supply.

**STEP 3:** Turn the browning control dial to the desired setting. Select 3–4 for medium brown toast.

**STEP 4:** Insert the bread or toasting food into the toasting slot(s) and lower the loading lever until it is locked into place. Toasting will begin when the loading lever is fully down.

**STEP 5:** When the toast reaches the desired browning level, the toast will pop up automatically.

**STEP 6:** Turn the toaster off and unplug it from the mains power supply.

**STEP 7:** Remove the food and any crumbs from the toasting slot(s) using heat-resistant gloves. Gently lift the loading lever to raise the toast out of the toasting slot(s) so that it can be more easily removed.

**NOTE:** To interrupt toasting mid-setting, press 'Cancel'. The cancel button will remain illuminated throughout the toasting cycle.

**CAUTION:** Never use a fork or sharp-edged utensil to remove toast, as this may damage the heating element or cause injury.

## Using the Defrost Setting

The defrost setting allows you to defrost bread or toast bread from frozen.

**STEP 1:** Make sure that the removable crumb tray is pushed fully into the toaster and that the loading lever is in the upright position.

**STEP 2:** Plug in and switch on the toaster at the mains power supply.

**STEP 3:** Turn the browning control dial to the desired setting.

**STEP 4:** Insert the frozen bread into the toasting slot(s) and lower the loading lever until it is locked into position. Defrosting will begin when the loading lever is fully lowered and 'Defrost' has been pressed (this will remain illuminated throughout the defrost process).

**STEP 5:** When the defrost setting has completed its cycle, the bread will pop up automatically.

**STEP 6:** If the bread has not fully defrosted, repeat steps 4–5. To interrupt the cycle, press 'Cancel'.

**STEP 7:** Switch off and unplug the toaster from the mains power supply.

**STEP 8:** Remove the food from the toasting slot(s) using heat-resistant gloves. Gently lift the loading lever to raise the toast out of the toasting slot(s) so that it can be more easily removed.

## Using the Reheat Setting

The reheat setting allows you to reheat toast which has gone cold.

**STEP 1:** Make sure that the crumb tray is pushed fully into the toaster and that the loading lever is in the upright position.

**STEP 2:** Plug in and switch on the toaster at the mains power supply.

**STEP 3:** Set the browning control dial to the desired setting.

**STEP 4:** Insert the cold toast into the toasting slot(s) and lower the loading lever until it is locked into position. Reheating will begin once the loading lever is fully down and 'Reheat' has been pressed (this will remain illuminated throughout the reheating process).

**STEP 5:** When the reheat setting has completed its cycle, the bread will pop up automatically.

**STEP 6:** If the bread has not fully reheated, repeat steps 4–5. To interrupt the cycle, press 'Cancel'.

**STEP 7:** Switch off and unplug the toaster from the mains power supply.

**STEP 8:** Remove the food from the toasting slot(s) using heat-resistant gloves. Gently lift the loading lever to raise the toast out of the toasting slot(s) so that it can be more easily removed.

## Automatic Centring Guides

Lowering the loading lever closes the centring guides and holds the bread centrally in the toasting slots.

**NOTE:** The loading lever will not lock down unless the toaster is plugged into the mains power supply and switched on.



## **Crumb Tray**

The toaster is equipped with a crumb tray, which should be periodically emptied so that the toaster operates correctly.

To remove the crumb tray, which is situated at the back of the toaster housing, pull the back handle towards the user.

Empty the crumb tray and then reinsert it, pushing it until it clicks back into position.

## **Storage**

The toaster must be cool, clean and dry before storing in a cool, dry place.

Never wrap the cord tightly around the toaster; wrap it loosely to avoid causing damage.

## **Specifications**

Product code: EK5040

Input: 220–240 V~ 50/60 Hz

Output: 850 W

## Connection To The Mains

Please check that the voltage indicated on the product corresponds with your supply voltage.

### Important

As the colours in the mains lead of this appliance may not correspond with the coloured markings identifying the terminals in your plug, please proceed as follows:

The wires in the mains lead are coloured in accordance with the following code:

**Blue Neutral (N)**

**Brown Live (L)**

**Green/Yellow Earth ( $\equiv$ )**

**FOR UK USE ONLY** - Plug fitting details  
(where applicable).

The wire coloured **BLUE** is the **NEUTRAL** and must be connected to the terminal marked **N** or coloured **BLACK**.

The wire coloured **BROWN** is the **LIVE** wire and must be connected to the terminal marked **L** or coloured **RED**.

The wire coloured **GREEN/YELLOW** must be connected to the terminal marked with the letter **E** or marked  $\equiv$ .

On no account must either the **BROWN** or the **BLUE** wire be connected to the **EARTH** terminal ( $\equiv$ ).

Always ensure that the cord grip is fastened correctly.

The plug must be fitted with a fuse of the same rating already fitted and conforming to BS 1362 and be ASTA approved.

If in doubt, consult a qualified electrician who will be pleased to do this for you.

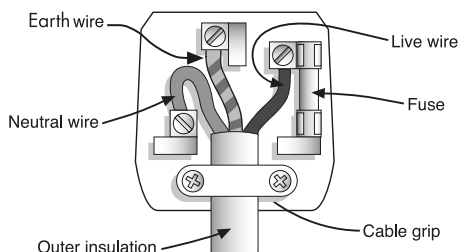

## Non-Rewireable Mains Plug

If your appliance is supplied with a non-rewireable plug fitted to the mains lead and should the fuse need replacing, you must use an ASTA approved one (conforming to BS 1362 of the same rating).

If in doubt, consult a qualified electrician who will be pleased to do this for you.

If you need to remove the plug, **DISCONNECT IT FROM THE MAINS**, then cut it off the mains lead and immediately dispose of it safely. Never attempt to reuse the plug or insert it into a socket outlet as there is a danger of an electric shock.

**UP Global Sourcing UK Ltd.,  
UK. Manchester OL9 0DD.  
Germany. 51149 Köln.**

If this product does not reach you in an acceptable condition please contact our Customer Services Department at [www.salterhousewares.co.uk](http://www.salterhousewares.co.uk)

Please have your delivery note to hand as details from it will be required.

If you wish to return this product, please return it to the retailer from where it was purchased with your receipt (subject to their terms and conditions).

## **Guarantee**

All products purchased as new carry a manufacturer's guarantee; the time period of the guarantee will vary dependent upon the product. Where reasonable proof of purchase can be provided, Salter will provide a standard 12 month guarantee with the retailer from the date of purchase. This is only applicable when products have been used as instructed for their intended, domestic use. Any misuse or dismantling of products will invalidate any guarantee.

Under the guarantee, we undertake to repair or replace free of any charge any parts found to be defective. In the event that we cannot provide an exact replacement, a similar product will be offered or the cost refunded. Any damages from daily wear and tear are not covered by this guarantee, nor are consumables such as plugs, fuses etc.

Please note that the above terms and conditions may be updated from time to time and we therefore recommend that you check these each time you revisit the website.

Nothing in this guarantee or in the instructions relating to this product excludes, restricts or otherwise affects your statutory rights.

## **Disposal of Waste Batteries and Electrical and Electronic Equipment**



This symbol on the product, its batteries or its packaging means that this product and any batteries it contains must not be disposed of with household waste. Instead, it is the user's responsibility to hand this over to an applicable collection point for the recycling of batteries and electrical and electronic equipment. This separate collection and recycling will help to conserve natural resources and prevent potential negative consequences for human health and the environment due to the possible presence of hazardous substances in batteries and electrical and electronic equipment, which could be caused by inappropriate disposal. Some retailers provide take-back services which allow the user to return exhausted equipment for appropriate disposal. **It is the user's responsibility to delete any data on electrical and electronic equipment prior to disposal.** For more information about where to drop batteries, electrical and electronic waste off, please contact the local city/municipality office, household waste disposal service, or the retailer.

\*To be eligible for the extended guarantee, go to **guarantee.upgs.com/salter/** and register your product within 30 days of purchase.



Find us on 

[www.facebook.com/SalterUK](http://www.facebook.com/SalterUK)

# SALTER®

Manufactured by:

UP Global Sourcing UK Ltd.,  
UK. Manchester OL9 0DD.  
Germany. 51149 Köln.

Made in China.

©Salter trademark. All rights reserved.

