

# User manual

Cordless jug blender

---

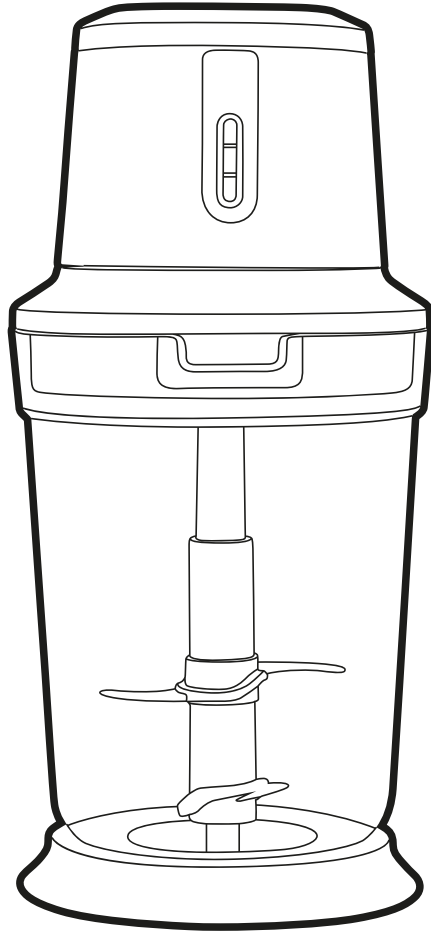

## Description of parts

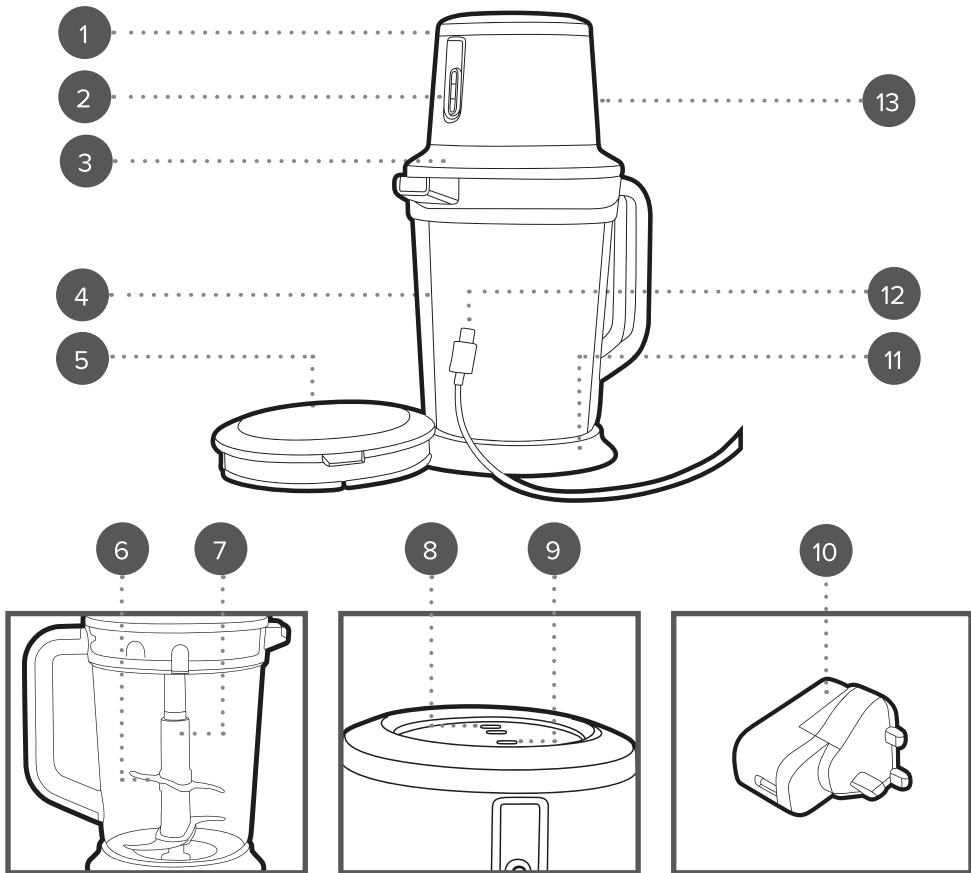

1. Jug blender motor unit
2. Indicator lights
3. Blender collar
4. Blending jug
5. Storage lid
6. Stainless steel blades
7. Blending rod

8. High speed button
9. Low speed button
10. Charging adaptor
11. Non-slip base
12. USB Type-C charging cable
13. Charging port

Please retain instructions for future reference.

## **SAFETY INSTRUCTIONS**

- When using electrical appliances, basic safety precautions should always be followed.
- Check that the voltage indicated on the rating plate corresponds with that of the local network before connecting the appliance to the mains power supply.
- Children aged from 8 years and people with reduced physical, sensory or mental capabilities or lack of experience and knowledge can use this appliance, only if they have been given supervision or instruction concerning use of the appliance in a safe way and understand the hazards involved.
- Children should be supervised to ensure that they do not play with the appliance.
- Unless they are older than 8 and supervised, children should not perform cleaning or user maintenance.
- This appliance is not a toy.
- If the power charging cable, plug or any part of the appliance is malfunctioning or if it has been dropped or damaged, cease using the product immediately to avoid potential injury.
- This appliance contains no user serviceable parts, only a qualified electrician should carry out repairs. Improper repairs may place the user at risk of harm.
- Keep the appliance and its charging cable out of the reach of children.
- Keep the appliance out of the reach of children when it is switched on or cooling down.
- Keep the appliance and its charging cable away from heat or sharp edges that could cause damage.
- Keep hands, fingers, hair and any loose clothing away from the rotating tools of the appliance.
- Do not immerse the electrical components of this appliance in water or any other liquid.
- Do not operate the appliance with wet hands.
- Do not leave the appliance unattended whilst connected to the mains power supply.
- Do not remove the appliance from the mains power supply by pulling the charging cable; switch it off and remove the plug by hand.
- Do not pull or carry the appliance by its charging cable.
- Do not use the appliance if it has been dropped, if there are visible signs of damage or if it is leaking.
- Do not use the appliance for anything other than its intended use.
- Do not use any accessories other than those supplied.
- Do not use any damaged accessories.
- Do not use this appliance outdoors.
- Do not store the appliance in direct sunlight or in high humidity conditions.
- Do not move the appliance whilst it is in use.
- Do not dry blend ingredients; always add a small amount of liquid.
- Do not overload the appliance as the mixture level may rise during blending.
- Do not touch any moving parts on this appliance during use, as this could cause injury.
- Do not touch any sections of the appliance that may become hot during use, as this could cause injury.

- Do not use broken or loose cutting or rotating blades.
- Always unplug the appliance after use and before any cleaning or user maintenance.
- Always ensure that the appliance has cooled fully after use before performing any cleaning or maintenance.
- Use of an extension cord with the appliance is not recommended.
- This appliance should not be operated by means of an external timer or separate remote control system.
- This appliance is intended for domestic use only. It should not be used for commercial purposes.



**WARNING:** Do not touch sharp blades.

### Rechargeable batteries (non-removable)

- The supply terminals are not to be short-circuited.
- In the event of a battery and cell leaking, do not allow the liquid to come in contact with the skin or eyes. If contact has been made, wash the affected area with copious amounts of water and seek medical advice.
- Secondary cells and batteries need to be charged before use. After extended periods of storage, it may be necessary to charge and discharge the cells or batteries several times to obtain maximum performance.
- Keep batteries out of the reach of children.
- Do not crush, puncture, dismantle or otherwise damage batteries.
- Do not store above 60 °C.
- Avoid storage in direct sunlight.
- Do not dispose of exhausted batteries in household waste.
- Do not expose the batteries to heat or fire as they may explode.
- Once the batteries have been exhausted, dispose of the product at a local recycling station. Contact the local government offices for further details.
- This product is fitted with a 2000 mAh Li-ion battery pack (non-removable).

### Care and maintenance

**STEP 1:** Switch off and unplug the jug blender from the mains power supply before performing any cleaning or user maintenance.

**STEP 2:** Wipe the jug blender motor unit with a soft, damp cloth and allow to dry thoroughly.

**STEP 3:** Wash the accessories in warm, soapy water, then rinse and dry thoroughly.

Never touch the stainless steel blades; using extreme caution, clean the blades with a brush and dry carefully.

Do not immerse the jug blender motor unit in water or any other liquid.

Do not use harsh or abrasive detergents or scourers to clean the jug blender, as this could cause damage.

The jug blender is not suitable for use in a dishwasher.



**NOTE:** Always clean the jug blender immediately after each use.



**WARNING:** Handle the stainless steel blades with care, as the blades are sharp. Exercise caution when attaching, removing, cleaning or storing the stainless steel blades.

## Instructions for use

### Before first use

**STEP 1:** Clean the jug blender and its accessories following the instructions in the section entitled '**Care and maintenance**'.

**STEP 2:** Place the jug blender motor unit onto a stable, heat-resistant surface, at a height that is comfortable for the user.



**NOTE:** When using the jug blender for the first time, a slight odour may be emitted. This is normal and will soon subside. Allow for sufficient ventilation around the jug blender.



**WARNING:** Do not immerse the jug blender motor unit in water or any other liquid. Never use harsh or abrasive cleaning detergents or scourers to clean the jug blender or its accessories, as this could cause damage.

### Charging the jug blender

**STEP 1:** Open the charging port on the jug blender motor unit and insert the Type-C USB end of the USB charging cable.

**STEP 2:** Insert the USB end of the USB charging cable into the charging adaptor.

**STEP 3:** Plug the charging adaptor into the mains power supply; the indicator lights will flash during charging and then remain illuminated once the battery is fully charged. See the section entitled '**Indicator lights**' for further details.



**NOTE:** The jug blender is shipped with approx. 30% charge in the batteries and so one or two of the indicator lights will be illuminated during use. However, the jug blender will not operate properly without charging and so it is recommended to fully charge the jug blender before first use for optimum performance. It will take approx. 5 hours to fully charge the jug blender.



**CAUTION:** The jug blender should only be charged using the adaptor and cable provided (DZ012ELU050200B). Do not use the adaptor or cable with any other appliance.

### Assembling the jug blender

**STEP 1:** Carefully hold the stainless steel blades by the blending rod and push onto the metal pin in the bottom of the blending jug until secure.

**STEP 2:** Align the U-shaped recesses on the blender collar with the U shapes in the blending jug and push in place.

**STEP 3:** Align the pins in the blender collar with the small openings in the jug blender motor unit and secure into position. The jug blender motor unit should fit flush with no gaps.

### Using the jug blender

The stainless steel blades must be securely fitted before use; do not attempt to remove or disassemble the jug blender until the stainless blades have stopped moving.

**STEP 1:** Secure the stainless steel blades into position following the instructions in the section entitled '**Assembling the jug blender**'.

**STEP 2:** Place the food to be blended into the blending jug; do not overfill.

**STEP 3:** Fit the blender collar and jug blender motor unit onto the blending jug, as instructed in the section entitled ‘**Assembling the jug blender**’. The indicator lights will flash to indicate that the jug blender is ready to use.

**STEP 4:** To blend the ingredients, press either the low ‘**I**’ or high ‘**II**’ speed button on top of the jug blender motor unit. Do not shake or move the jug blender whilst it is operating.

**STEP 5:** Stop the blending process by releasing the relevant speed button.

**STEP 6:** Make sure that the stainless steel blades have completely stopped before removing the jug blender motor unit and blender collar.

**STEP 7:** Carefully remove the stainless steel blades by firmly grasping the blending rod and lifting up, exercising caution when handling sharp blades.



**CAUTION:** Switch off the jug blender before adding or removing food from the blending jug.



**WARNING:** Do not operate the jug blender without food as this can cause damage. Maximum operation time is 1 minute. Allow to cool for 5 minutes before using the jug blender again. This will prevent damage to the motor.

**Indicator lights**  
**Battery remaining indicator**

<b>X X X</b>	66–100% Charge
<b>X X</b>	33–65% Charge
<b>X</b>	20–30% Charge
<b>X (Flashing)</b>	<20% Charge and the jug blender needs to be charged

**Charging Indication (Indicator Lights whilst Charging)**

<b>X X X (Flashing)</b>	<33% Charge
<b>X (Solid) X X (Flashing)</b>	33–65% Charge
<b>X X (Solid) X (Flashing)</b>	66–99% Charge
<b>X X X (Solid)</b>	>99% Charge

**Motor cut-off indication**

The motor has an automatic protection system that will not allow overloading or overheating. If the load is too large, or the jug blender is used for too long, it will automatically shut off. If the jug blender senses an overload situation, all 3 indicator lights will flash 5 times and the jug blender will turn off. Release the speed button and the lights will turn off. Reduce the load on the jug blender, allow it to rest for 15 minutes and then resume use.

## Troubleshooting

Problem	Possible cause	Solution
The jug blender will not operate.	The jug blender is not charged.	Charge the jug blender following the instructions in the section entitled ' <b>Charging the jug blender</b> '.
The stainless steel blades will not move when in contact with ingredients.	The ingredients are hard vegetables such as potato, carrot and turnip, making it difficult for the jug blender to blend.	Only blend ingredients such as cooked vegetables or soft fruit.
The stainless steel blades will not move when in contact with ingredients.	Food has become lodged around the stainless steel blades.	Use a spatula to carefully dislodge the trapped food: do not use fingers as the stainless steel blades are sharp.

## Storage

Reassemble the jug blender.

Check that the jug blender is cool, clean and dry before storing in a cool, dry place.

## Specifications

Product code: EK5393

Product output:  10.8 V 200 W

Adaptor input: 100–240 V ~ 50/60 Hz 0.5 A Max

Adaptor output: 5 V  2.0 A 10 W

Average active efficiency: ≥78.70%

Efficiency at low load (10%): ≥73%

No-load power consumption: ≤0.1W



#### Disposal of Waste Batteries and Electrical and Electronic Equipment



This symbol on the product, its batteries or its packaging means that this product and any batteries it contains must not be disposed of with household waste. Instead, it is the user's responsibility to hand this over to an applicable collection point for the recycling of batteries and electrical and electronic equipment. This separate collection and recycling will help to conserve natural resources and prevent potential negative consequences for human health and the environment due to the possible presence of hazardous substances in batteries and electrical and electronic equipment, which could be caused by inappropriate disposal. Some retailers provide take-back services which allow the user to return exhausted equipment for appropriate disposal. **It is the user's responsibility to delete any data on electrical and electronic equipment prior to disposal.** For more information about where to drop batteries, electrical and electronic waste off, please contact the local city/municipality office, household waste disposal service, or the retailer.

Manufactured by:  
Ultimate Products UK Ltd.,  
Victoria Street, Manchester OL9 0DD. **UK.**  
Ultimate Products Europe Ltd.,  
19 Baggot Street Lower, Dublin D02 X658. **ROI.**

**MADE IN CHINA.**

CD160123/MD210323/V2