

# **SALTER<sup>®</sup>**

S I N C E 1 7 6 0



## **Manual Hand-crank Juicer**

For fresh juice on the go

## Before First Use

Hand-wash all of the accessories carefully in warm, soapy water. Rinse and dry thoroughly.

## Description of Parts

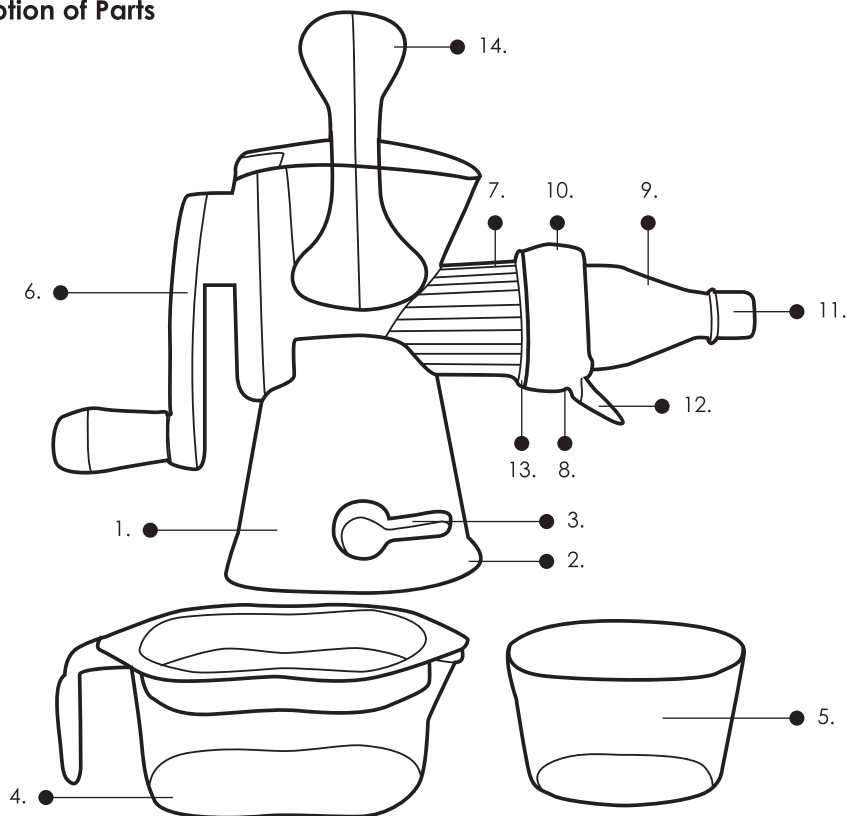

- |    |                         |     |                   |
|----|-------------------------|-----|-------------------|
| 1. | Juicer main unit        | 8.  | Juice nose cone   |
| 2. | Suction base            | 9.  | Funnel            |
| 3. | Suction base lock       | 10. | Locking mechanism |
| 4. | Juice jug with strainer | 11. | Pulp nozzle       |
| 5. | Pulp container          | 12. | Juice spout       |
| 6. | Hand-crank              | 13. | Gasket            |
| 7. | Juicing spindle         | 14. | Pusher            |

## Assembling the Juice Nose Cone

**STEP 1:** Hold the locking mechanism so that the locking slots can be seen and insert the pointed end of the funnel until the locking slots and locking tabs at the top of the funnel are sat flush.

**STEP 2:** Keeping hold of the locking mechanism, insert the juice spout into the slot on the side so that it sits below the lip of the locking mechanism holding all three components together.

**STEP 3:** Place the pulp nozzle onto the tip of the funnel and twist it in a clockwise direction to secure.

**STEP 4:** Position the gasket into the locking mechanism so that it sits onto the ledge created by the assembled juice nose cone.

**Note:** Before attaching the juice nose cone to the juicer, check that the gasket is in place.

## Assembling the Juicer

**STEP 1:** Place the juicer main unit onto a flat and dry, stable surface and apply pressure to the suction base. Lock the juicer main unit into position by turning the suction base lock in a clockwise direction until it is in the 'lock' position.

**STEP 2:** Attach the juicing spindle to the juicer by securing the square end of the juicing spindle into the lower cog inside of the juicer main unit.

**STEP 3:** Attach the hand-crank to the juicer main unit by inserting the metal bar on the hand-crank into the upper cog.

**STEP 4:** Ensuring that the juice nose cone is fully assembled, place it over the end of the juicing spindle until it reaches the juicer main unit. Twist the juice nose cone in a clockwise direction to lock it into place.

**Note:** When the juice nose cone is fully attached, the juice spout should be pointing downwards.

## Using the Juicer

Once the juicer is fully assembled:

**STEP 1:** Position the juice jug with strainer underneath the juice spout, ready to collect the extracted juice.

**STEP 2:** Position the pulp container underneath the pulp nozzle, ready to collect any pulp or waste from the fruit.

**STEP 3:** Place the chosen fruit inside the juicer main unit, ensuring that there is maximum contact between the fruit and the juicing spindle. Use the pusher to apply gentle pressure to the fruit and then begin juicing by turning the hand-crank in a clockwise direction so that the juicing spindle rotates towards the juice nose cone.

**STEP 4:** Juice will be extracted from the fruit and will flow out of the juice spout into the juice jug with strainer. Continue turning the hand-crank until the desired amount of juice has been produced.

**Note:** Fruits that work best include oranges, lemons, melons, apples and pears.

For best results, ensure that the chosen fruit is fully ripe.

Larger fruit may have to be cut into smaller pieces in order to fit inside the juicer main unit.

It is not essential for fruit with thin skins, such as apples and pears, to be fully peeled; however, the flesh part of the fruit should be in contact with the juicing spindle for optimal juice extraction.

## Cleaning the Manual Hand-crank Juicer

The Manual Hand-crank Juicer is not dishwasher suitable.

After use, disassemble the Manual Hand-crank Juicer and clean all of its parts in warm, soapy water with a mild detergent and a soft cloth; do not use harsh or abrasive cleaners or scourers; rinse and dry thoroughly, immediately after use.

Do not submerge the juicer main unit in water or any other liquid, as this will affect the suction base stability mechanism.

**Caution:** Take care when handling the juicing spindle due to the sharp edges.

## Storage

Do not store wet; store in a clean, dry place.

Please retain this information for future reference.

If this product proves unsatisfactory or if you have any further queries, please contact your retailer.

Distributed by:  
UP Global Sourcing,  
Victoria Street,  
Manchester OL9 0DD. UK.  
Made in China.

**SALTER®**

CD190716/MD000000/V1